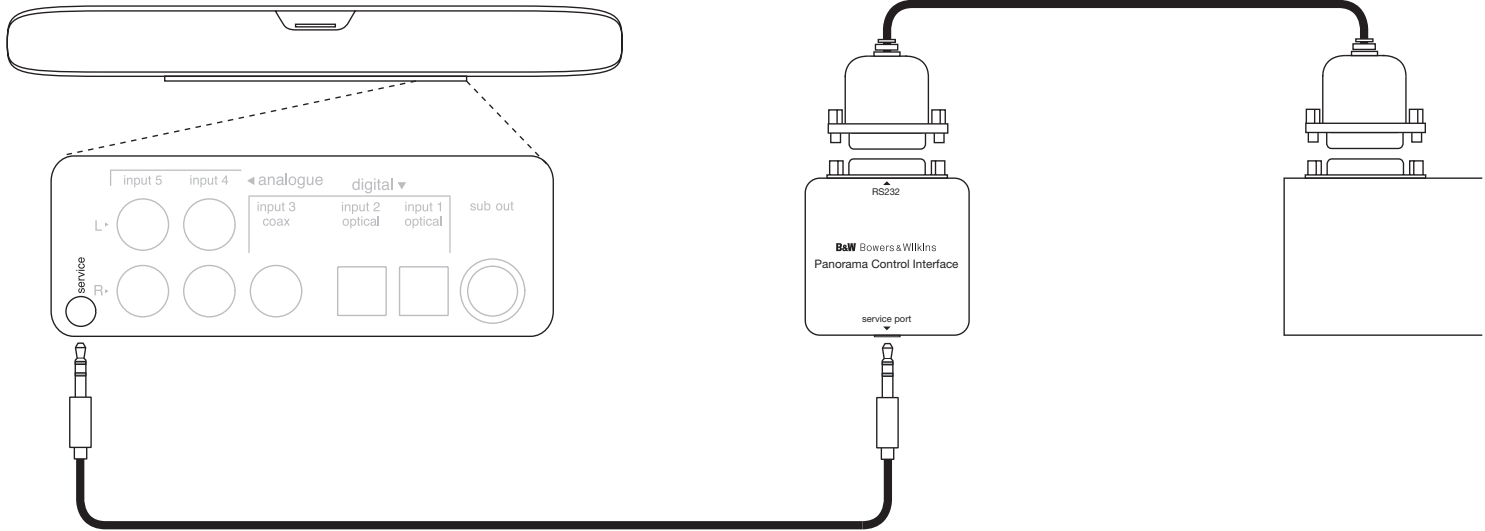

Figure 1



Bowers & Wilkins

B&W Group Ltd
Dale Road
Worthing West Sussex
BN11 2BH England

T +44 (0) 1903 221800
F +44 (0) 1903 221801
info@bwgroup.com
www.bowers-wilkins.com

B&W Group (UK Sales)
T +44 1903 221 500
E uksales@bwgroup.com

B&W Group North America
T +1 978 664 2870
E marketing@bwgroupusa.com

B&W Group Asia Ltd
T +852 2 790 8903
E info@bwgroup.hk

Panorama Service Interface Instructions

Bowers & Wilkins

1. CONTROLLING PANORAMA VIA THE SERVICE PORT

1.1 Location

Panorama can be controlled via the “service port”. This is basically a RS232 connection with non-standard connector and voltage levels.

Panorama has the service port located on the rear connector panel. It is indicated by the word “service”. This port accepts a 3.5mm stereo jack. See Figure 1.

1.2 Interface for Panorama service port

A small interface is required to convert the Panorama service port signals to standard RS232 signals and physical DB-9 connector. See Figure 1.

1.3 RS232 Communication Parameters

The RS232 parameters settings are:

- 19200 baud
- 8 databits
- No parity
- 1 stopbit
- no handshaking

1.4 Command Protocol

Panorama can be controlled by sending strings of characters via the service port.

Every string consists of:

- 1 character indicating the command
- body with variable number of characters
- <CR>
- <LF> (optional)

1.5 Command List

Each command strings should be terminated with <CR> and optionally <LF>.

(*) This setting is not remembered after mains disconnect (not stored in permanent memory). After poweron, the keys are always enabled.

(**) “x” is the ASCII character of (vol + 48)
(vol is a value between 0 and 34)
Example: set volume 18: vB <CR>

Following commands are used to request information from Panorama:

Command	Description	Answer from Panorama
N	Ask for firmware version	N2xx2yy xx = version of microcontroller yy = version of DSP

Command	Description
R1	On/standby toggle
R2	Volume up (1 step)
R3	Mute toggle
R5	Mode toggle (stereo – wide – surround)
R6	Volume down (1 step)
R7	Input toggle (IN 1, 2, 3, 4, 5)
R8	Voice toggle
R:	Select IN5
R;	Select IN4
R<	Select IN1
R=	Select IN2
R>	Select IN3
R?	Standby
R@	On
RA	Stereo
RB	Wide
RC	Surround
RD	Mute off
RE	Mute on
RF	Voice off
RG	Voice on
K0	Keylock disable (local and remote keys)
K1	Keylock activated (local and remote keys) (*)
vx (*)	Set volume directly to x (**)