

B&W Bowers & Wilkins

Nautilus™ 800 Series

Nautilus™800
Owner's Manual
and Warranty



Figure 1

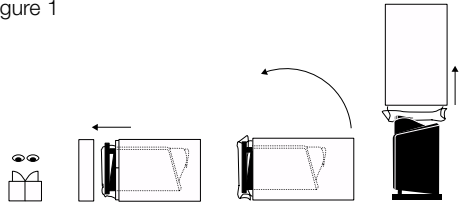

Figure 2

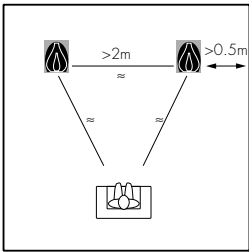

Figure 3a

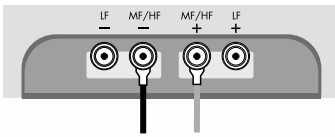

Figure 3b

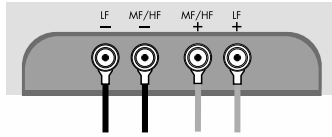

Figure 4

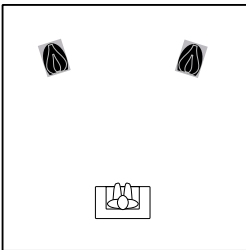
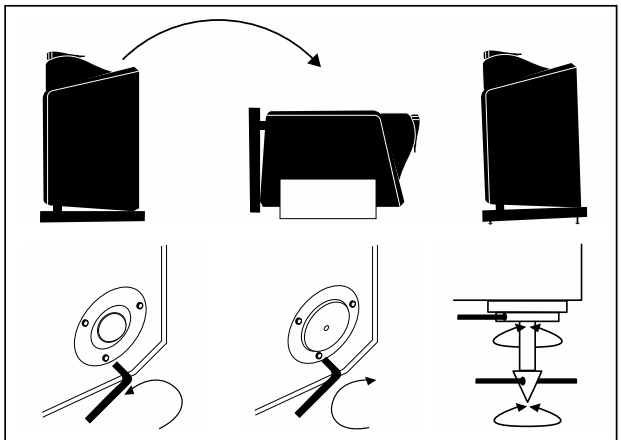

Figure 5



Contents

English

Limited Warranty.....	1
Owner's Manual.....	1

Français

Garantie limitée.....	3
Manuel d'utilisation	3

Deutsch

Beschränkte Garantie	6
Bedienungsanleitung.....	6

Español

Garantía limitada.....	9
Manual de instrucciones	9

Português

Garantia limitada.....	12
Manual do utilizador....	12

Italiano

Garanzia limitata	14
Manuale di istruzioni ...	15

Nederlands

Beperkte garantie	17
Handleiding	17

Dansk

Begrænset garanti	20
Bruksanvisning	20

Svenska

Begränsad garanti	22
Bruksanvisning	22

Ελληνικά

Περιορισμένη εγγύηση	24
Οδηγίες Χρήσεως	25

Русский

Ограниченная гарантия.....	28
Руководство по эксплуатации	28

日本語

有限保証	31
取扱説明書	31

中文

有限擔保	33
用戶說明書	33

English

Limited Warranty

Dear customer,

Welcome to B&W.

This product has been designed and manufactured to the highest quality standards. However, if something does go wrong with this product, B&W Loudspeakers and its national distributors warrant free of charge labour (exclusion may apply) and replacement parts in any country served by an official B&W distributor.

This limited warranty is valid for a period of five years from the date of purchase or two years for electronics including amplified loudspeakers.

Terms and Conditions

- 1 The warranty is limited to the repair of the equipment. Neither transportation, nor any other costs, nor any risk for removal, transportation and installation of products is covered by this warranty.
- 2 This warranty is only valid for the original owner. It is not transferable.
- 3 This warranty will not be applicable in cases other than defects in materials and/or workmanship at the time of purchase and will not be applicable:
 - a. for damages caused by incorrect installation, connection or packing,
 - b. for damages caused by any use other than correct use described in the user manual, negligence, modifications, or use of parts that are not made or authorised by B&W,
 - c. for damages caused by faulty or unsuitable ancillary equipment,
 - d. for damages caused by accidents, lightning, water, fire heat, war, public disturbances or any other cause beyond the reasonable control of B&W and its appointed distributors,
 - e. for products whose serial number has been altered, deleted, removed or made illegible,
 - f. if repairs or modifications have been executed by an unauthorised person.
- 4 This guarantee complements any national/regional law obligations of dealers or national distributors and does not affect your statutory rights as a customer.

How to claim repairs under warranty

Should service be required, please follow the following procedure:

- 1 If the equipment is being used in the country of purchase, you should contact the B&W authorised dealer from whom the equipment was purchased.
- 2 If the equipment is being used outside the country of purchase, you should contact B&W national distributor in the country of residence who will advise

where the equipment can be serviced. You can call B&W in the UK or visit our web site to get the contact details of your local distributor.

To validate your warranty, you will need to produce this warranty booklet completed and stamped by your dealer on the date of purchase. Alternatively, you will need the original sales invoice or other proof of ownership and date of purchase.

Owner's manual

Introduction

Thank you for choosing Bowers & Wilkins.

Your Nautilus™800 speakers are precision transducers incorporating many innovative techniques unique to B&W and capable of reproducing recorded sound to the highest standards. So that they may perform at their best, it is essential to take time and care with the installation process. In particular, you must regard the listening room as an extension of the speaker. The acoustic character of the room can have a profound effect on the final sound quality.

Please read this manual fully before unpacking and installing the product. It will help you to optimise its performance. B&W maintains a network of dedicated distributors in over 60 countries who will be able to help you should you have any problems your dealer cannot resolve.

Unpacking (figure 1)

The product is extremely heavy and will require more than one person to unpack and position it safely.

We recommend you wear gloves and strong shoes to avoid personal injury in case of accident. Observe the normal rules of good posture when lifting heavy objects to avoid strain. Remove any rings and bracelets to avoid damage to the surfaces of the product.

- By the time you read this manual, the carton should be lying on the floor with the speaker face up, as indicated by the printing on the side of the carton.
- Remove the lower packing tray to expose the plinth of the speaker.
- Open the bag and pull it clear of plinth.
- Stand the speaker upright and remove the remainder of the packing.
- Remove the transit clamp from the rear of the speaker, following the instruction on the label. (This reveals a large slotted tensioning screw. The position of the screw is factory set to optimise the anti-vibration mount of the midrange driver and should not be altered).

We suggest you retain the packing for future use.

Check in the accessory pack for:

- 4 foot receptacles
- 4 Screw-in spike foot tips (pre-fitted to receptacles)

- 4 Screw-in foot pads
- 1 Midrange unit centre-bullet
- 1 Midrange unit grille
- 1 Allen key
- 1 Foot adjustment bar
- 1 Cleaning Cloth
- 1 Leather Cleaner (odd numbered carton only)

Wood is a natural material and veneers vary between batches. Although supplied as single units, systems with consecutive serial numbers (odd number lower) have veneer-matched cabinets. Please be aware that if more than two speakers are purchased for a single installation, B&W cannot guarantee they will all be veneer matched.

Positioning (figure 2)

The speakers are provided with ball glides on the underside of the plinth to facilitate movement.

However, to prevent the weight of the speaker causing damage to non-carpeted floors, place a piece of felt or carpet under the plinth and slide the speaker into position. To manoeuvre the speaker without tipping, push low down on the cabinet.

Both spike feet (for carpeted floors) and padded feet (for wooden and other vulnerable floors) are provided as an alternative to the roller ball glides. However, we do not recommend you fit these until after the optimum position for the speakers has been determined.

To find the optimum position in the room may involve a certain amount of experimentation, but as an initial guide:

- Position the speakers and the centre of the listening area approximately at the corners of an equilateral triangle.
- Keep the speakers at least 2m apart to maintain left-right separation.
- The speakers are designed to be free-standing and will generally perform best when positioned at least 0.5m (20-in) from walls.

The proximity of the speakers to walls affects the sound quality. See the section "Fine Tuning" below.

Stray magnetic fields

The speaker drive units create stray magnetic fields that extend beyond the boundaries of the cabinet.

We recommend you keep magnetically sensitive articles (television and computer screens, computer discs, audio and video tapes, swipe cards and the like) at least 0.5m from the speaker.

Connections (figure 3)

All connections should be made with the equipment switched off.

The high quality WBT® terminals accept a variety of cable terminations to suit most applications. For either 6mm (1/4 in) or 8mm (5/16 in) spades, use the larger diameter section of the screw caps. For

4mm banana plugs, use the smaller diameter section of the screw caps, which loosens or tightens a collet round the plug. In all cases, make sure both sections are screwed down in use to prevent rattling.

Important safety notice:

In certain countries, notably those in Europe, the use of 4mm banana plugs is considered a potential safety hazard, because they may be inserted into the holes of unshuttered mains supply sockets. In order to comply with European CENELEC safety regulations, the 4mm holes in the ends of the terminals are blocked by plastic pins. Do not remove the pins if you are using the product where these conditions apply.

There are 2 pairs of terminals at the back of the speaker. The outermost (LF) pair feed the bass drivers and the innermost (MF/HF) pair feed the midrange and tweeter. This separation of the inputs to each section of the speaker allows a choice of connection methods.

On delivery, both positive and both negative terminals are connected together with high-quality links for use with single 2-core cable. If you wish to use single cable connection, the links must be left in place. Because high frequency signals are more readily degraded by contact connections, we recommend you connect the cable directly to the innermost (MF/HF) terminals (figure 3a). Even if you finally intend to use a more complex connection method, single cable connection aids free movement of the speakers during initial setting up. There is enough clearance to fit a spade connector on top of a link.

Separation of the signal paths to each section of the speaker can improve imaging and the resolution of low-level detail and allows the user to optimise the cable to the frequency range of use. Bi-wiring involves the use of two separate 2-core cables from the same amplifier, one to each pair of terminals on the speaker. Bi-amplification involves the use of two separate power amplifier channels for each speaker. In both cases, the links should be removed from the speaker terminals (figure 3b).

Ensure each positive terminal on the speaker (coloured red) is connected to the positive output terminal of the amplifier and negative (coloured black) to negative. Incorrect connection may result in impairment of frequency response, poor imaging and loss of bass.

If using bi-amplification, ensure that each amplifier channel has the same gain, otherwise you will change the balance of the speaker. Check the absolute polarity. Some amplifiers invert the signal, and a mixture of different types may cause a dip in the overall response. If you have a mixture of inverting and non-inverting amplifiers, reverse the polarity of the connections from any inverting amplifier to the speaker. Bear in mind that, even though midrange and, even more so, tweeter drivers can (and only need to) handle less continuous power than bass drivers, the amplifier feeding them needs to have an adequate voltage swing in order to

supply the short-term high-frequency peaks in music without distortion. A high voltage capability implies high power, so it is not particularly desirable to have a lower power amplifier feeding the midrange and tweeter than is used for the bass drivers.

Fine tuning

Before fine tuning, double check that all the connections in the installation are correct and secure.

Positioning the speakers:

Moving the speakers further from the walls will reduce the general level of bass. Space behind the speakers also helps to create an impression of depth. Conversely, moving the speakers closer to the walls will increase the level of bass.

If the bass is uneven with frequency it is usually due to the excitation of resonance modes in the room.

Even small changes in the position of the speakers or the listeners can have a profound effect on how these resonances affect the sound. Try mounting the speakers along a different wall. Even moving large pieces of furniture can have an effect.

If the central image is poor, try moving the speakers closer together or toeing them in so they point at or just in front of the listeners. (figure 4)

Room acoustics:

If the sound is too harsh, increase the amount of soft furnishing in the room (for example use heavier curtains), or reduce it if the sound is dull and lifeless.

Test for flutter echoes by clapping your hands and listening for rapid repetitions. Reduce them by the use of irregular shaped surfaces such as bookshelves and large pieces of furniture.

If you still suffer poor results due to the acoustics of the listening room, consult your dealer about more substantial acoustic treatment.

Fitting the alternative feet: (figure 5)

Most speakers perform best, particularly in terms of bass attack and timing, given a firm mechanical foundation. Unless you wish to move the speakers on a regular basis, we recommend you replace the ball glides on the underside of the plinth with the alternative feet supplied.

Switch off the equipment and disconnect the cables from the terminals.

- Use at least two people to manoeuvre the speaker. Remove rings and bracelets to avoid scratching the speaker surfaces.
- Lay the speaker on its back, resting on the polystyrene packing cradle to protect it from the floor.
- Replace the ball glides with the conical foot receptacles, using the Allen key provided.
- If you have a carpeted floor, fully screw in the spike foot tips, otherwise use the flat foot pads.

- Return the speaker to the upright position.
- If the speaker rocks on two of the feet, unscrew the other two feet equally, using the bar provided, until the speaker stands firmly on the floor.

If the seating position is particularly low, the speaker may be tilted forward. The spike may be extended to a maximum of 45mm (1.75in) from the foot receptacles. Screw the front two feet in as far as possible and extend the rear feet evenly to suit. Adjust the rear feet to eliminate rocking and tighten the lock nuts.

Fitting the midrange grille:

A grille is supplied in the accessory pack to cover the midrange drive unit if desired. Fitting the grille also requires the centre bullet of the drive unit to be replaced by the alternative version with a hole in the tip from the accessory pack. To fit the alternative centre bullet, simply unscrew the fitted part and screw in the replacement, taking care not to damage the voice coil former. Hand tighten only.

Running-in period

The performance of the speaker will change subtly during the initial listening period. If the speaker has been stored in a cold environment, the damping compounds and suspension materials of the drive units will take some time to recover their correct mechanical properties. The drive unit suspensions will also loosen up during the first hours of use. The time taken for the speaker to achieve its intended performance will vary depending on previous storage conditions and how it is used. As a guide, allow up to a week for the temperature effects to stabilise and 60 hours of average use for the mechanical parts to attain their intended design characteristics.

Ancillary equipment

Speakers of this ability deserve signals of the highest quality. Choose your electronic equipment and interconnecting cables with care. We can give guidance on what to look for when choosing ancillary equipment, but cannot recommend specific items. The standards of such products are improving all the time and your dealer will be able to demonstrate a variety of suitable up-to-date products.

In the specification we recommend a range of amplifier powers. The higher figure is defined by the power handling capability of the speaker. When calculating the power handling, it is assumed that the amplifier is not run into clipping, which distorts the frequency power spectrum of the signal, and that the signal is normal programme material. Test tones from oscillators and the like are not applicable. The lower figure is the minimum we consider necessary to achieve reasonable listening levels without audible distortion in the smaller room (less than 60 m³ or 2000 cu ft). The higher the power you use, the less likely you are to experience amplifier clipping. You can often tell how good an amplifier is at driving complex speaker loads by looking at its power rating into both 4Ω and 8Ω loads.

The nearer the ratio is to 2:1 the better, as it indicates a good current capability.

In order to reduce the effect the cable has on the frequency response of the speaker to inaudible levels, the impedance of the cable at all frequencies (measuring both positive and negative conductors in series) should be kept as low as possible and certainly below 0.1Ω. At low frequencies, the DC resistance of the cable is the dominant factor and you should choose a gauge of wire sufficient to achieve the impedance requirements over the length of cable you need to use. At mid and high frequencies the inductive component of the impedance can dominate the DC resistance. This and other properties influenced by the detailed construction of the cable become important. Ask your dealer for advice on the best cable for your needs.

Aftercare

Most of the enclosure surfaces simply require dusting and you may use the cloth provided in the accessory pack to wipe small marks from the gloss surfaces. The surfaces may also benefit from the occasional use of an antistatic cleaner. However, such cleaners may damage the leather covering the top and front of the bass cabinet and the drive units themselves. For that reason, do not spray from an aerosol directly onto the product. Apply the cleaner first to a soft cloth, but for this purpose, do not use the cloth provided in the accessory pack.

The leather cleaner supplied in the accessory pack will maintain the quality of the leather on your speakers for many years. If you wish to use it on other leather, we advise you test it first on a nonobtrusive area of the article, DO NOT USE THIS PRODUCT ON ANILINE (UNFINISHED) LEATHER.

In its diluted form, the leather cleaner is supplied to remove ingrained dirt, grime and mild grease deposits.

Directions for use:

- 1) Make a solution of one part cleaner to twelve parts very hot water.
- 2) Immerse a soft cloth in this solution, wring out cloth and rub lightly over the surface to be cleaned.
- 3) Remove a residue of cleaner solution with a fresh cloth dampened with clean water.

Avoid touching the drive unit diaphragms, especially the tweeter, as damage may result.

Français

Garantie limitée

Cher Client,

Bienvenue à B&W.

Ce produit a été conçu et fabriqué en vertu des normes de qualité les plus rigoureuses. Toutefois, en cas de problème, B&W Loudspeakers et ses distributeurs nationaux garantissent une main d'œuvre (exclusions possibles) et des pièces de rechange gratuites dans tout pays desservi par un distributeur agréé de B&W.

Cette garantie limitée est valide pour une période de cinq ans à compter de la date d'achat ou une période de deux ans pour les composants électroniques, y compris les haut-parleurs amplifiés.

Conditions

- 1 La garantie est limitée à la réparation de l'équipement. Les frais de transport ou autres, les risques associés à l'enlèvement, au transport et à l'installation des produits ne sont pas couverts par cette garantie.
- 2 La garantie est exclusivement réservée au propriétaire d'origine et ne peut pas être transférée.
- 3 Cette garantie ne s'applique qu'aux produits faisant l'objet de vices de matériaux et/ou de construction au moment de l'achat et ne sera pas applicable dans les cas suivants :
 - a. détériorations entraînées par une installation, connexion ou un emballage incorrect,
 - b. détériorations entraînées par un usage autre que l'usage correct décrit dans le manuel de l'utilisateur, la négligence, des modifications ou l'usage de pièces qui ne sont pas fabriquées ou agréées par B&W,
 - c. détériorations entraînées par un équipement auxiliaire défectueux ou qui ne convient pas,
 - d. détériorations résultant de : accidents, foudre, eau, chaleur, guerre, troubles de l'ordre public ou autre cause ne relevant pas du contrôle raisonnable de B&W ou de ses distributeurs agréés,
 - e. les produits dont le numéro de série a été modifié, effacé, éliminé ou rendu illisible,
 - f. les produits qui ont été réparés ou modifiés par une personne non autorisée.
- 4 Cette garantie vient en complément à toute obligation juridique nationale / régionale des revendeurs ou distributeurs nationaux et n'affecte pas vos droits statutaires en tant que client.

Comment faire une réclamation en vertu de la garantie

Veillez respecter la procédure ci-dessous, si vous souhaitez faire une réclamation sous garantie :

- 1 Si l'équipement est utilisé dans le pays d'achat, veuillez contacter le distributeur agréé de B&W qui a vendu l'équipement.
- 2 Si l'équipement est utilisé dans un pays autre que le pays d'achat, veuillez contacter le distributeur national B&W du pays de résidence, qui vous indiquera où vous pouvez faire réparer l'équipement. Vous pouvez appeler B&W au Royaume-Uni ou consulter notre site Web pour obtenir les coordonnées de votre distributeur local.

Afin de valider votre garantie, vous devrez présenter ce livret de garantie qui aura été rempli et tamponné par votre revendeur le jour de l'achat. En l'absence de ce livret, vous devrez présenter l'original de la facture commerciale ou une autre preuve d'achat et de la date d'achat.

Manuel d'utilisation

Introduction

Nous vous remercions d'avoir choisi Bowers & Wilkins.

Vos enceintes acoustiques de la série Nautilus™800 sont des transducteurs de précision, comprenant de nombreuses techniques innovantes, uniques à B&W. Elles sont capables de reproduire vos enregistrements au niveau de qualité le plus élevé. Pour obtenir les meilleures performances, il est essentiel de consacrer le temps et l'attention nécessaires à leur installation. En particulier vous devez absolument considérer que la salle d'écoute est une extension acoustique des enceintes. Le tempérament acoustique de la salle peut donc avoir une influence profonde sur la qualité sonore finale.

Nous vous recommandons de lire attentivement ce manuel avant de débaler et d'installer les appareils. Il vous aidera à optimiser leurs performances.

B&W a constitué un réseau de distributeurs dans plus de 60 pays. Ils sont en mesure de vous assister au cas où votre revendeur ne pourrait vous aider.

Déballage (figure 1)

Ces matériels sont extrêmement lourds. Ils requièrent plus d'une personne pour un déballage et une mise en place exempts de risques. Nous vous recommandons d'utiliser des gants et des chaussures solides ; ils vous protégeront de toute blessure éventuelle. Vous observerez les règles élémentaires de bonne posture qui sont applicables lorsque l'on soulève un objet lourd et encombrant ; elles vous éviteront un éventuel tour de reins. Retirez bagues et bracelets pour ne pas risquer de rayer la surface de l'appareil.

- Couchez le carton sur le sol, face avant de l'enceinte orientée vers le haut, conformément aux indications imprimées sur l'emballage.

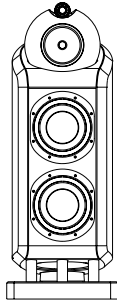

Nautilus™800

Technical Features	Nautilus™ tweeter Nautilus™ head Kevlar® brand fibre cone FST midrange Matrix cabinet Flowport
Description	3-way vented-box system
Drive units	1x ø25mm (1 in) metal dome high-frequency 1x ø150mm (6in) woven Kevlar® cone FST midrange 2x ø250mm (10 in) paper/Kevlar® cone bass
Frequency range	-6dB at 25Hz and 50kHz -3dB at 32Hz and 42kHz
Frequency response	37Hz - 23kHz ±2dB on reference axis
Dispersion	Within 2dB of response on reference axis Horizontal: over 60° arc Vertical: over 10° arc
Sensitivity	91dB spl (2.83V, 1m)
Harmonic distortion	2nd and 3rd harmonics (90dB, 1m) <1.0% 45Hz - 20kHz <0.5% 50Hz - 20kHz
Nominal impedance	8Ω (minimum 3.0Ω)
Crossover frequencies	350Hz and 4kHz
Power handling	50W – 1000W into 8Ω on unclipped programme
Max. recommended cable impedance	0.1Ω
Dimensions	Height: 1197mm (47.1 in) Width: 450mm (17.7 in) Depth: 645mm (25.4 in)
Net Weight	125kg (275 lb)